

# Plat of Survey

of

## Part of Lot 1, Lot 2 and Lot 3 of Certified Survey Map No. 979,

recorded in Vol. 4 of Certified Survey Maps of Walworth County on Page 242 and located in Government Lot 6 of Section 8, Town 4 North, Range 18 East, Town of East Troy, Walworth County, Wisconsin.

Portion of Lot not surveyed described in a Quit Claim Deed recorded June 16, 1987 in Vol. 404 on Page 577 as Document No. 148526 as shown below:  
A parcel of land being part of Lot 1 of Certified Survey Map No. 979, located in the S.W. 1/4 of Section 8, T4N, R18E, Walworth County, Wisconsin, described as follows: Begin at a point on the North Line of said Lot 1, said point being on the meander line of Lake Beulah S. 88°42' E. 16 feet, more or less from the shore of said Lake Beulah; thence S 43°40'39" E. along said meander line, 50.00 feet; thence N. 47°11' E. 50.81 feet to the North line of said Lot 1; thence N. 88°42' W. along said North line, 71.74 feet to the point of beginning. Also to include all the land between above described meander line and the shore of said Lake Beulah.

## Part of Lot 4 of Certified Survey Map No. 1651,

recorded in Vol. 7 of Certified Survey Maps of Walworth County on Page 298 and located in the Northwest 1/4 of Section 8, Town 4 North, Range 18 East, Town of East Troy, Walworth County, Wisconsin.

Said part of Lot 4 described in a Quit Claim Deed recorded December 23, 1991 in Vol. 546 on Page 762 as Document No. 223796 as shown below:  
Part of Tax Parcel PA-1651-4A being part of Lot 4 of Certified Survey Map No. 1651, located in Section 8, Town 4 North, Range 18 East, Town of East Troy, Walworth County, Wisconsin, described as follows: Begin at the Southwest Corner of said Tax Parcel and Lot 4; thence N 2°34'27" E 143.44 feet; thence S 88°42'00" E 145.18 feet; thence S 1°12'34" W 143.41 feet; thence N 88°42'00" W 148.60 feet to the Point of Beginning.

Also lands described in a Quit Claim Deed recorded December 23, 1991 in Vol. 546 on Page 762 as Document No. 223797 as shown below:  
Part of Tax Parcel PA-1651-4A being part of Lot 4 of Certified Survey Map No. 1651, located in Section 8, Town 4 North, Range 18 East, Town of East Troy, Walworth County, Wisconsin, described as follows: Commence at the Southwest Corner of said Tax Parcel and Lot 4; thence S 88°42'00" E 148.60 feet to the Point of Beginning; thence N 1°12'34" E 143.41 feet; thence S 88°42'00" E 293.32 feet; thence S 2°09'14" W 143.42 feet; thence N 88°42'00" W 290.95 feet to the Point of Beginning.

## Also unplatted lands,

located in the Northwest 1/4 of Section 8, Town 4 North, Range 18 East, Town of East Troy, Walworth County, Wisconsin.

Lands described in a Quit Claim Deed recorded June 16, 1987 in Vol. 404 on Page 578 as Document No. 148527 as shown below:  
A parcel of land located in the N.W. 1/4 of Section 8, T4N, R18E, Walworth County, Wisconsin, described as follows: Commence at the West 1/4 corner of said Section 8; thence S 88°42' E. along the East West 1/4 Line of said Section 8, 1011.58 feet; thence N. 2°20'53" E., 749.88 feet; thence S. 88°49'58" E. 290 feet; thence S. 2°40'59" W. 150 feet; thence S. 88°42' E. 880.00 feet; thence S. 2°34'27" W. 456.14 feet to the point of beginning; thence continue S. 2°34'27" W. 143.44 feet to the East-West 1/4 Line of said Section 8; thence N. 88°42' W., along said quarter line, 144.71 feet; thence W. 47°11' E. 206.01 feet to the point of beginning.

Lake

Beulah

Surveyed for: **Estate of Odilia M. Zielinski**

1046 Ryans Run  
Boothwyn, Pennsylvania, 19061

## Proposed Lot Line Adjustment from Tax Parcel PA165100004A1 to Tax Parcel PA 97900001

Part of Lot 4 of Certified Survey Map No. 1651, located in the Northwest 1/4 of Section 8, Town 4 North, Range 18 East, Town of East Troy, Walworth County, Wisconsin, described as follows: Begin at an iron rod at the Southwest corner of said Lot 4; thence North 2°34'01" East, along the West line of said Lot 4, 143.44 feet to an iron rod; thence South 0°26'53" East 143.47 feet to an iron pipe at the Northeast corner of Lot 1 of Certified Survey Map No. 979; thence North 88°42'00" West, along the South line of said Lot 4 of Certified Survey Map No. 1651, also being the North line of said Lot 1 of Certified Survey Map No. 979, 7.55 feet to the Point of Beginning.

Said parcel contains 0.012 acre (541 sq.ft.) of land, more or less, and is a lot line adjustment from Tax Parcel PA165100004A1 to Tax Parcel PA 97900001.

This lot line adjustment is for the purpose of a sale or exchange between adjoining land owners that does not create additional lots and the original parcels are not reduced below the minimum size required by the Walworth County Code of Ordinances (Zoning/Shoreland Zoning).

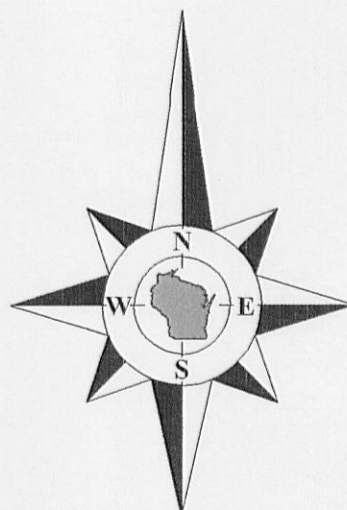
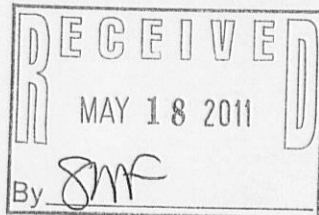

Bearings referenced to Certified Survey Map No. 979.

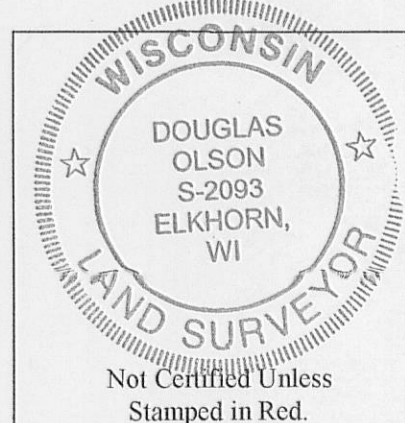

### Notes:

- This survey plat is not certified unless signed and sealed in red ink.
- This survey is subject to Wisconsin lien laws. This Plat of Survey is the notice of intent to file lien. Lien waiver required.

Lot 4  
Itsa Little Subdivision

(S88°42'00"E ±204.9')  
S88°33'54"E ±198.5'

Part of Lot 4  
C.S.M. 1651

Tax Parcel  
PA165100004A1

0.483 Acre  
21,039 Sq.Ft.  
Vol. 546 Page 762  
Doc. No. 223796.

Proposed Lot  
Line Adjustment

0.012 Acre  
541 Sq.Ft.

Unplatted Land

0.238 Acre  
10,385 Sq.Ft.  
Vol. 404 Page 578  
Doc. No. 148527.

Part of Lot 1  
C.S.M. 979

Tax Parcel  
PA 97900001

0.547 Acre  
23,812 Sq.Ft.

Lot 2  
C.S.M. 979

Tax Parcel  
PA 97900002

0.658 Acre  
28,668 Sq.Ft.

Lot 3  
C.S.M. 979

Tax Parcel  
PA 97900003

0.865 Acre  
37,691 Sq.Ft.

Part of Lot 4  
C.S.M. 1651

Tax Parcel  
PA165100004A

0.957 Acre  
41,692 Sq.Ft.  
Vol. 546 Page 763  
Doc. No. 223797.

Portion of  
Tax Parcel  
PA165100004A  
In Lake  
0.675 Acre  
29,412 Sq.Ft.

Lake

Beulah

### Legend

- Found County Section Corner
- Found Iron Pipe
- Recorded Information
- Utility Box or Pedestal
- Light Pole Surface
- Gravel Surface

Sheet 1 of 1 Sheets

Drawing Name: I:\ar\82\2010068B-2010068B.Dwg

Job Reference Number

2010.068 B, C, D

2010.068 B, C, D

Jensen & Olson Land Surveying, LLC

45 South Wisconsin Street \* P.O. Box 322 \* Elkhorn, Wisconsin. 53121

Telephone: (262) 723-3434 \* Facsimile: (262) 723-8044

Email: jensen.olson@elknet.net

Survey date: October 21, 2010.

Revisions: Rev. 1 - Misc. Adjustment  
Rev. 2 - Misc. Adjustment

Scale in Feet

1" = 20'

